

BT SERIES

BAND-IT ADAPTOR

INTERFACE: F

TO FIT TYPICAL CONNECTOR: MIL-DTL-38999 SERIES I & II

For modifications see page:



➤ Visit our on-line catalogue or contact sales on ➤ www.polamco.com ➤ sales@polamco.co.uk

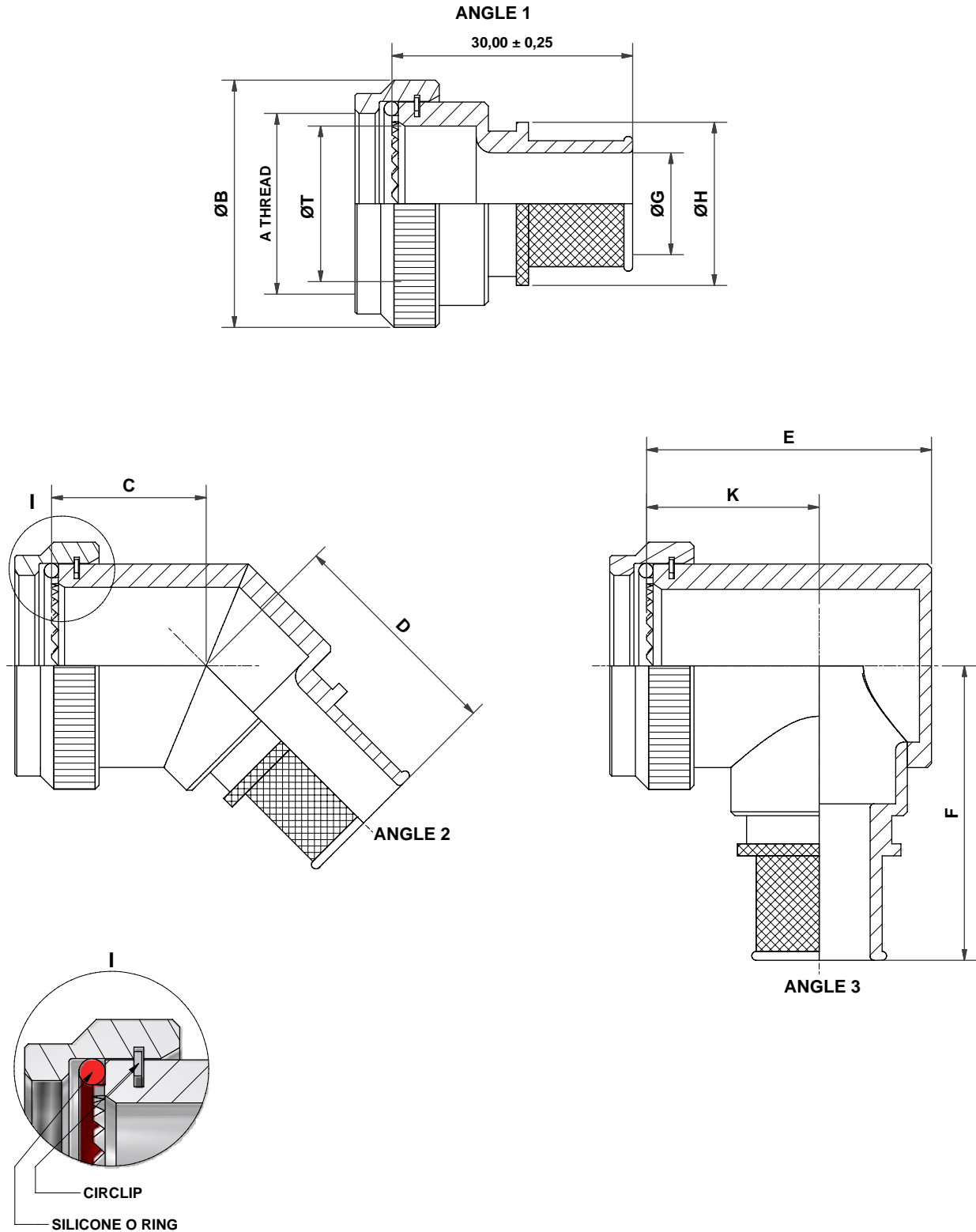

DRAWING NOT TO SCALE
DIMENSIONS IN MM

IF THIS DOCUMENT IS PRINTED IT BECOMES UNCONTROLLED. CHECK THE LATEST ISSUE.

NCAGE CODE U5792



BT SERIES

BAND-IT ADAPTOR

INTERFACE: F

TO FIT TYPICAL CONNECTOR: MIL-DTL-38999 SERIES I & II

For modifications see page:



➤ Visit our on-line catalogue or contact sales on ➤ www.polamco.com ➤ sales@polamco.co.uk

| EXAMPLE PART NUMBER | BT F 1 - 16 - 08 - 1 - C - SB |
|--|-------------------------------|
| SERIES | BT |
| CONNECTOR INTERFACE | F |
| ANGLE | 1 |
| DASH NUMBER (TABLE 1) | 16 |
| ENTRY SIZE (TABLE 2) | 08 |
| MATERIAL (1-ALUMINIUM ALLOY) | 1 |
| PLATING (TABLE 3) | C |
| BAND REF | SB |
| OMIT FOR NON-STANDARD | |
| FOR ALTERNATIVES SEE MODIFICATION PAGE | |

| DASH NO. | MIL-DTL-38999 SHELL SIZE | | A THREAD | B MAX | T MIN | C +/-0,5 | D MAX | E MAX | F MAX | K +/- 0,5 |
|----------|--------------------------|-----------|----------------|-------|-------|----------|-------|-------|-------|-----------|
| | SERIES I | SERIES II | | | | | | | | |
| 08 | 9 | 8 | 7/16-28 UNEF | 18,3 | 6,6 | 16,4 | 24,7 | 22,7 | 30,4 | 15,0 |
| 10 | 11 | 10 | 9/16-24 UNEF | 21,5 | 10,1 | 17,2 | 25,9 | 26,2 | 32,2 | 17,0 |
| 12 | 13 | 12 | 11/16-24 UNEF | 24,5 | 12,9 | 17,6 | 26,3 | 29,2 | 33,7 | 18,0 |
| 14 | 15 | 14 | 13/16-20 UNEF | 27,8 | 16,1 | 18,5 | 27,2 | 32,2 | 35,2 | 20,0 |
| 16 | 17 | 16 | 15/16-20 UNEF | 30,8 | 19,3 | 19,2 | 28,0 | 35,7 | 36,9 | 21,5 |
| 18 | 19 | 18 | 1 1/16-18 UNEF | 34,1 | 21,7 | 19,6 | 28,3 | 39,7 | 38,5 | 23,0 |
| 20 | 21 | 20 | 1 3/16-18 UNEF | 37,3 | 24,9 | 20,4 | 29,1 | 42,2 | 41,1 | 25,0 |
| 22 | 23 | 22 | 1 5/16-18 UNEF | 40,5 | 28,1 | 20,8 | 29,5 | 45,2 | 41,6 | 26,0 |
| 24 | 25 | 24 | 1 7/16-18 UNEF | 43,7 | 31,3 | 21,7 | 30,4 | 48,2 | 43,1 | 28,0 |

| ENTRY SIZE | G MIN | H MAX |
|------------|-------|-------|
| 03 | 4,77 | 13,9 |
| 04 | 6,35 | 13,9 |
| 05 | 7,92 | 15,5 |
| 06 | 9,52 | 17,2 |
| 07 | 11,10 | 18,7 |
| 08 | 12,70 | 20,3 |
| 09 | 14,27 | 21,9 |
| 10 | 15,88 | 23,5 |
| 11 | 17,47 | 25,1 |
| 12 | 19,05 | 26,7 |
| 13 | 20,62 | 28,3 |
| 14 | 22,23 | 29,9 |
| 15 | 23,82 | 31,5 |
| 16 | 25,40 | 33,1 |
| 17 | 27,00 | 34,7 |
| 18 | 28,60 | 36,3 |
| 19 | 30,20 | 37,9 |
| 20 | 31,80 | 39,5 |
| 21 | 33,38 | 41,1 |
| 22 | 35,00 | 42,7 |
| 23 | 36,58 | 44,3 |
| 24 | 38,10 | 45,9 |

| CODE | PLATING |
|------|--|
| B | CADMIUM OLIVE DRAB OVER ELECTROLESS NICKEL |
| C | ELECTROLESS NICKEL |
| ZB | ZINC COBALT OLIVE DRAB OVER ELECTROLESS NICKEL |

LIST NOT EXHAUSTIVE - FOR COMPREHENSIVE LIST AND SPECS SEE WEBSITE

DRAWING NOT TO SCALE
DIMENSIONS IN MM

IF THIS DOCUMENT IS PRINTED IT BECOMES UNCONTROLLED. CHECK THE LATEST ISSUE.

NCAGE CODE U5792

