

BT SERIES

BAND-IT ADAPTOR

INTERFACE: A

TO FIT TYPICAL CONNECTOR: MIL-DTL-26482 SERIES II, MIL-DTL-83723 SERIES III, MIL-DTL-5015H

For modifications see page:



➤ Visit our on-line catalogue or contact sales on ➤ www.polamco.com ➤ sales@polamco.co.uk

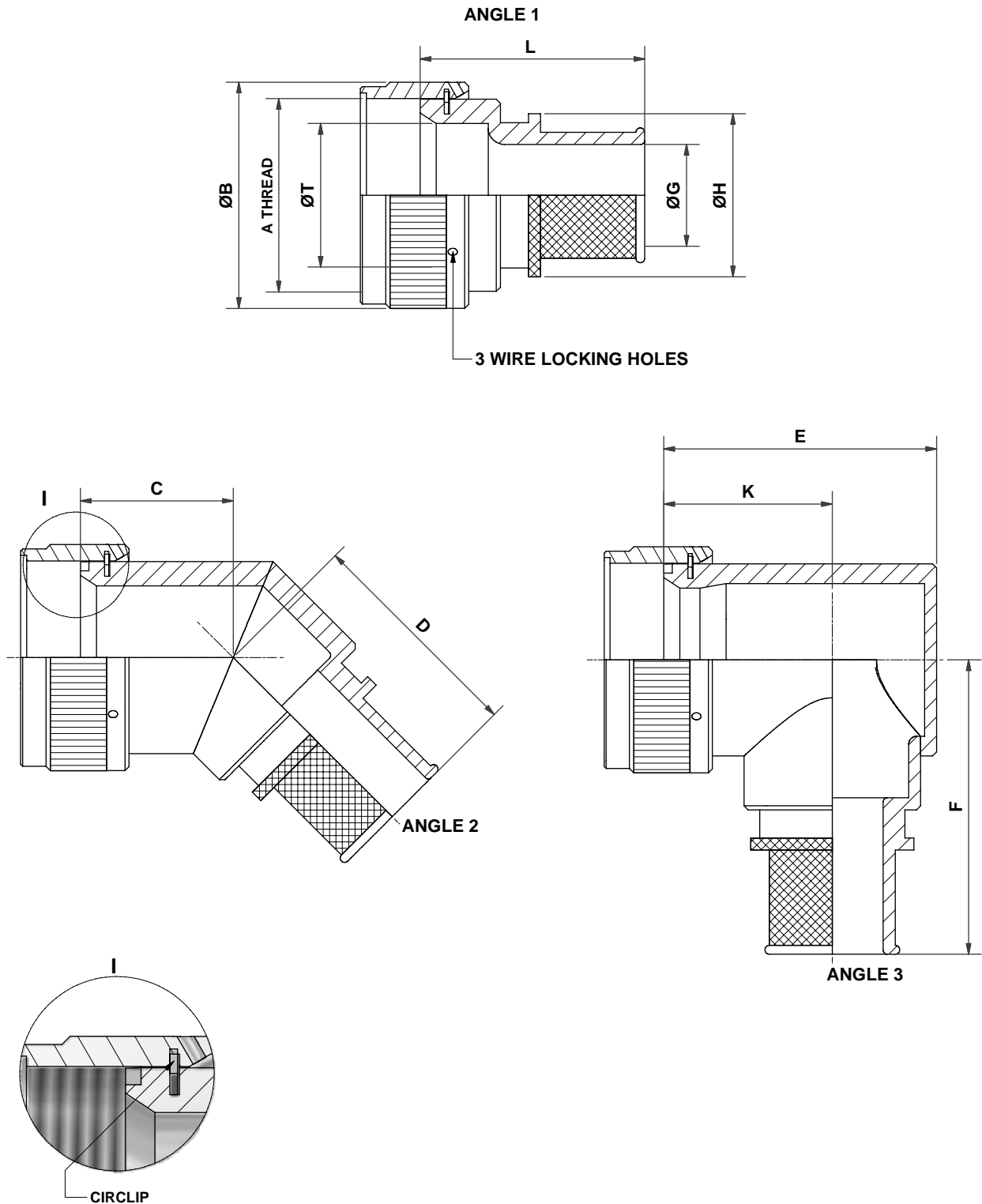

DRAWING NOT TO SCALE
DIMENSIONS IN MM

NCAGE CODE U5792



BT SERIES

BAND-IT ADAPTOR

INTERFACE: A

TO FIT TYPICAL CONNECTOR: MIL-DTL-26482 SERIES II, MIL-DTL-83723 SERIES III, MIL-DTL-5015H

For modifications see page:



➤ Visit our on-line catalogue or contact sales on ➤ www.polamco.com ➤ sales@polamco.co.uk

| | | | | | | | | |
|----------------------------|------------------------------|---|---|------|------|-----|-----|------|
| EXAMPLE PART NUMBER | BT | A | 1 | - 16 | - 08 | - 1 | - C | - SB |
| | SERIES | | | | | | | |
| | CONNECTOR INTERFACE | | | | | | | |
| | ANGLE | | | | | | | |
| | SHELL SIZE (TABLE 1) | | | | | | | |
| | ENTRY SIZE (TABLE 2) | | | | | | | |
| | MATERIAL (1-ALUMINIUM ALLOY) | | | | | | | |
| | PLATING (TABLE 3) | | | | | | | |
| | BAND REF | | | | | | | |

| SHELL SIZE | A THREAD | B MAX | T MIN | C +/- 0,5 | D MAX | E MAX | F MAX | K +/- 0,5 | L MAX |
|------------|----------------|-------|-------|-----------|-------|-------|-------|-----------|-------|
| 03 | 9/16-24 UNEF | 17,0 | * | 16,8 | 26,6 | 26,6 | 29,4 | * | 28,0 |
| 08 | 1/2-20 UNF | 15,6 | 6,7 | 16,6 | 26,4 | 24,7 | 30,5 | 17,5 | 28,0 |
| 10 | 5/8-24 UNEF | 18,6 | 9,4 | 16,8 | 26,2 | 26,7 | 32,2 | 17,8 | 28,0 |
| 12 | 3/4-20 UNEF | 21,7 | 12,9 | 17,3 | 26,1 | 29,2 | 32,0 | 18,7 | 28,0 |
| 14 | 7/8-20 UNEF | 24,9 | 14,8 | 18,1 | 27,9 | 30,7 | 33,6 | 19,0 | 28,0 |
| 16 | 1-20 UNEF | 28,2 | 17,9 | 19,0 | 28,2 | 34,2 | 36,9 | 21,0 | 28,0 |
| 18 | 1 1/16-18 UNEF | 30,9 | 19,9 | 19,2 | 29,1 | 37,2 | 36,9 | 23,5 | 28,0 |
| 20 | 1 3/16-18 UNEF | 34,1 | 23,1 | 20,1 | 29,3 | 42,2 | 38,5 | 27,0 | 28,0 |
| 22 | 1 5/16-18 UNEF | 37,3 | 26,3 | 20,3 | 29,6 | 44,2 | 40,1 | 27,0 | 28,0 |
| 24 | 1 7/16-18 UNEF | 40,4 | 29,2 | 21,8 | 31,5 | 45,2 | 41,8 | 27,0 | 28,0 |
| 28 | 1 3/4-18UNS | 50,0 | 34,9 | 23,3 | 32,1 | 54,4 | 45,6 | * | 40,0 |
| 32 | 2-18 UNS | 56,3 | 41,2 | 25,0 | 33,7 | 62,5 | 48,1 | * | 50,0 |
| 36 | 2 1/4-16 UN | 62,7 | 46,7 | 26,2 | 34,9 | 67,4 | 51,8 | 38,0 | 60,0 |
| 40 | 2 1/2-16 UN | 69,0 | 52,1 | 28,6 | 36,2 | 73,4 | 54,8 | * | 60,0 |
| 61 | 2 3/4-16 UN | 75,4 | * | 30,1 | 37,8 | 79,7 | 58,0 | 28,0 | 28,0 |

| ENTRY SIZE | G MIN | H MAX |
|------------|-------|-------|
| 03 | 4,7 | 13,9 |
| 04 | 6,3 | 13,9 |
| 05 | 7,9 | 15,5 |
| 06 | 9,5 | 17,2 |
| 07 | 11,1 | 18,7 |
| 08 | 12,7 | 20,3 |
| 09 | 14,2 | 21,9 |
| 10 | 15,8 | 23,5 |
| 11 | 17,4 | 25,1 |
| 12 | 19,0 | 26,7 |
| 13 | 20,6 | 28,3 |
| 14 | 22,2 | 29,9 |
| 15 | 23,8 | 31,5 |
| 16 | 25,4 | 33,1 |
| 17 | 27,0 | 34,7 |
| 18 | 28,6 | 36,3 |
| 19 | 30,2 | 37,9 |
| 20 | 31,8 | 39,5 |
| 21 | 33,3 | 41,1 |
| 22 | 35,0 | 42,7 |
| 23 | 36,5 | 44,3 |
| 24 | 38,1 | 45,9 |

| CODE | PLATING |
|------|--|
| B | CADMIUM OLIVE DRAB OVER ELECTROLESS NICKEL |
| C | ELECTROLESS NICKEL |
| ZB | ZINC COBALT OLIVE DRAB OVER ELECTROLESS NICKEL |

LIST NOT EXHAUSTIVE - FOR COMPREHENSIVE LIST AND SPECS SEE WEBSITE

DRAWING NOT TO SCALE
DIMENSIONS IN MM

NCAGE CODE U5792

